



YOUR NEW RESIDENCE AT HIGHLANDS





## TRIVILLAS, A STYLISH RETREAT

Trivillas thoughtfully-designed homes, each spanning on approximately 170m<sup>2</sup>, offer modern comforts. The open concept lay-out on the ground-floor encompasses refined interiors and alfresco living spaces overlooking a sun-kissed swimming pool, providing the possibility to taste the splendours of modern living. Ideal for a couple or a family, this contemporary residence features spacious bedrooms on the first floor with stylish subtle touches for restful nights. The stately property boasts a private carport and a landscaped garden.







## WARM AND CHIC INTERIORS

The stunning open-concept interior opens seamlessly on the ample outdoor spaces offering endless entertainment possibilities. The inviting and warm living room combines elegance and luxury. Each villa features high-end amenities and state-of-the-art appliances. The large openings infuse the interiors with natural light. Designed to be functional and to promote serenity and relaxation, Trivillas showcases ideal homes for busy urban families.



# MASTER PLAN



## TRIVILLAS, A STYLISH RETREAT

Just a few minutes from the vibrant and bustling centre of the island, Trivillas is a fine collection of three splendid villas opening on a private swimming pool await you! Nestled in a tranquil area in Highlands, these peaceful homes wrapped in lush gardens blend harmoniously with their natural surroundings. The verdant settings create an ambiance of timeless sanctuary and set the scene for quiet and cosy evenings and relaxing week-ends. The sleek design and modern architecture add a splash of striking modernity to the property.





GROUND-FLOOR  
95.55 m<sup>2</sup>

1	Main entrance	7.42 m <sup>2</sup>
2	Living & dining areas	28.89 m <sup>2</sup>
3	Kitchen	15.51 m <sup>2</sup>
4	Guest toilet	1.80 m <sup>2</sup>
5	Patio	4.07 m <sup>2</sup>
6	Bedroom 1	15.12 m <sup>2</sup>
7	Ensuite bathroom 1	3.96 m <sup>2</sup>
8	Laundry	5.13 m <sup>2</sup>

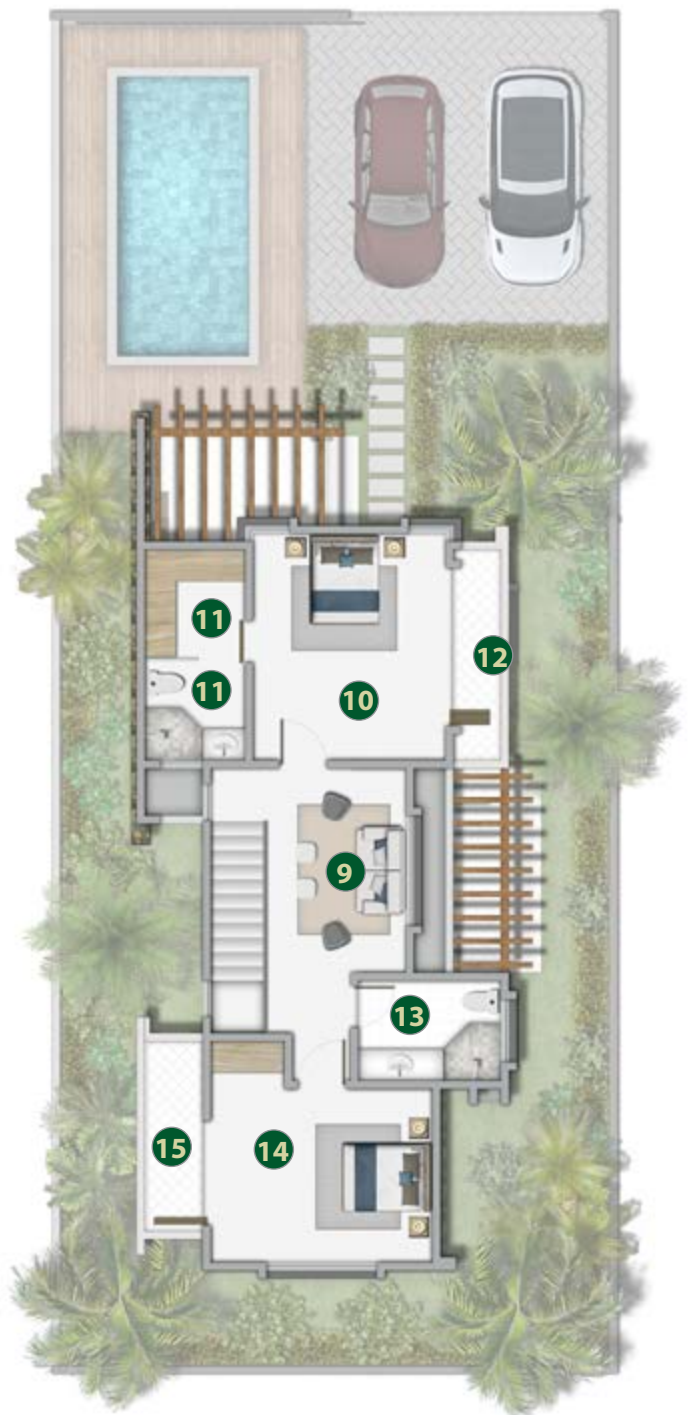

FIRST FLOOR  
81.36 m<sup>2</sup>

9	Lounge	13.35 m <sup>2</sup>
10	Master bedroom	15.70 m <sup>2</sup>
11	Ensuite bathroom & dressing	7.60 m <sup>2</sup>
12	Balcony (for master bedroom)	4.60 m <sup>2</sup>
13	Bedroom 2	15.12 m <sup>2</sup>
14	Ensuite bathroom 2	5.13 m <sup>2</sup>
15	Balcony 2	4.95 m <sup>2</sup>
<b>Total Built Area</b>		<b>176.91 m<sup>2</sup></b>
16	Pool	15.00 m <sup>2</sup>
17	Carport	42.00 m <sup>2</sup>



# HIGHLANDS

Incredibly private yet close to Ebene, Phoenix, Port-Louis and major road networks, Trivillas is conveniently located. Tucked away in an evergreen region, Highlands boasts several residential programs and developments. From this brand-new property's location, the Capital city, the airport, the beach and shopping and dining are within a short drive. Highland also benefits from a cool weather all year round.



Promoter: RAMAPPAN COMPANY LIMITED

Notary: ME WENDA SAWMYNADEN

Architect: P. SEEBURUN

Engineer: T. BHOWRUTH

Quantity Surveyor: SOMAH ASSOCIATES LIMITED

3D Illustrations & Graphic concept: XWORX LTD

RAMAPPAN COMPANY LIMITED  
Mobile no. : 5904 8530/5421 1469

Marketing & Sales: Davyland Properties Ltd

Tel no. : 208 7253

Email: [communication@davyland.mu](mailto:communication@davyland.mu)

[www.davylandproperties.com](http://www.davylandproperties.com)